

Butterfly Garden at Stony Brook Wildlife Sanctuary
October 2016

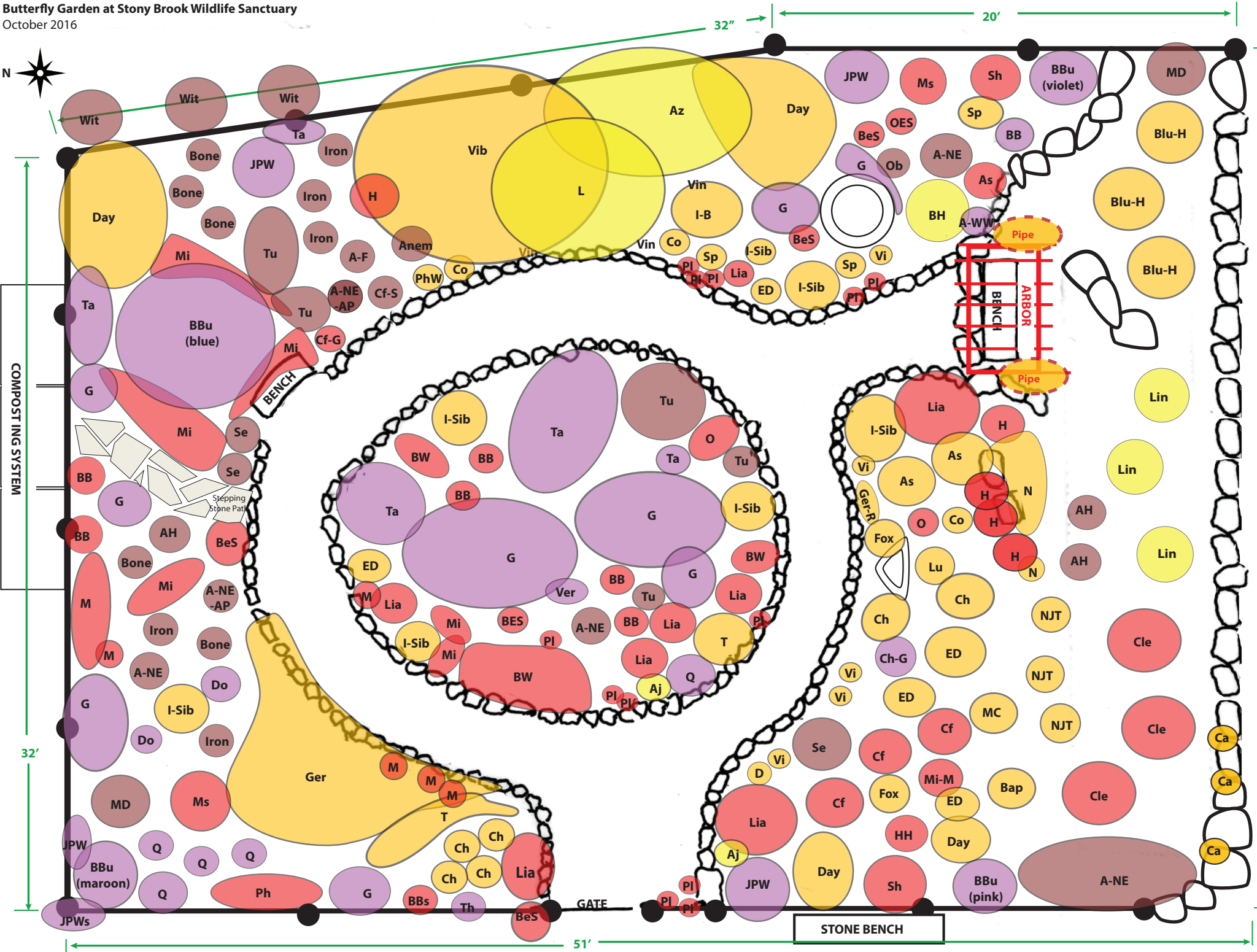

- PERENNIALS**
- A-F** - Frikart's Aster 'Monch' (*Aster x fricartii*)
 - A-NE** - Aster, NE (*Sympyotrichum novae-angliae*)
 - A-NE-AP** - Aster, NE 'Alma Plotschke' (*Sympyotrichum novae-angliae*)
 - A-NY** - Aster, NY (*Sympyotrichum novi-belgii*)
 - A-WW** - White Wood Aster (*Eurybia divericata*)
 - AH** - Anise Hyssop 'Blue Fortune' (*Agastache*)
 - Aj** - Ajuga (*Ajuga reptans*)
 - Anem** - Anemone 'September Charm' (*Anemone*)
 - As** - Astilbe
 - Az** - Azalea
 - Bap** - False Blue Indigo (*Baptisia australis*)
 - BB** - Bee Balm (*Monarda didyma*)
 - BBs** - Spotted Bee Balm (*Monarda punctata*)
 - BBu** - Butterfly Bush (*Buddleja davidii*)
 - BeS** - Black-eyed Susan (*Rudbeckia hirta*)
 - BH** - Bleeding Heart (*Lamprocapnos (Dicentra) spectabilis*)
 - Blu-H** - Highbush Blueberry (*Vaccinium corymbosum*)
 - Bone** - Boneset (*Eupatorium perfoliatum*)
 - BW** - Butterfly Weed (*Asclepias tuberosa*)
 - Ca** - Cactus, Prickly Pear (*Opuntia humifusa*)
 - Ch** - Chives (*Allium schoenoprasum*)
 - Ch-G** - Garlic Chives (*Allium tuberosum*)
 - Cf** - Purple Coneflower (*Echinacea purpurea*)
 - Cf-G** - Coneflower 'Goldsturm' (*Rudbeckia fulgida* var. *sullivantii*)
 - Cf-S** - Coneflower Sombbrero 'Salsa Red' (*Echinacea*)
 - Cle** - Clethra (*Clethra alnifolia*)
 - Co** - Columbine (*Aquilegia*)
 - D** - Dianthus
 - Do** - Curly Dock (*Rumex crispus*)
 - Day** - Daylily (*Hemerocalus fulva*)
 - ED** - Early Daisy (*Bellis perennis*)
 - Fox** - Foxglove (*Digitalis*)
 - G** - Goldenrod (*Solidago*)
 - Ger** - Geranium (*Geranium sanguineum*)
 - Ger-R** - Robert Geranium (*Geranium robertianum*)
 - H** - Hosta
 - Ho** - Hollyhock (*Alcea*)
 - I-B** - Bearded iris
 - I-Sib** - Siberian iris
 - Iron** - New York Ironweed (*Vernonia noveboracensis*)
 - JPW** - Joe-Pye Weed (*Eutrochium purpurea*)
 - JPWs** - Spotted Joe-Pye Weed (*Eutrochium maculatum*)
 - L** - Lilac
 - Lia** - Gayfeather/Liatris (*Liatris spicata*)
 - Lin** - Spicebush (*Lindera benzoin*)
 - Lu** - Lupine (*Lupinus polyphyllus*)
 - M** - Common Milkweed (*Asclepias syriaca*)
 - MC** - Maltese Cross (*Lychnis chaceldonica*)
 - Mi** - Mint (*Mentha*)
 - Mi-M** - Mountain mint (*Pycnanthemum virginianum*)
 - MD** - Montauk Daisy (*Nipponanthemum nipponicum*)
 - Ms** - Swamp Milkweed (*Asclepias incarnata*)
 - N** - Stinging Nettle (*Urtica dioica*)
 - NJT** - New Jersey Tea (*Ceanothus americanus*)
 - O** - Oregano (*Origanum vulgare*)
 - OES** - Ox-Eye Sunflower (*Heliopsis helianthoides*)
 - Ob** - Obedient Plant (*Physostegia virginiana*)
 - Pipe** - Pipevine (*Aristolochia macrophylla*)
 - Ph** - Phlox (*Phlox paniculata*)
 - PhW** - Woodland Phlox (*Phlox divaricata*)
 - PI** - English Plantain (*Plantago lanceolata*)
 - Q** - Wild Quinine (*Parthenium integrifolium*)
 - Se** - Sedum (*Hylotelephium X*)
 - Sh** - Shasta Daisy (*Leucanthemum X*)
 - Sp** - Spiderwort (*Tradescantia X*)
 - St-L** - Lesser stitchwort (*Stellaria graminea*)
 - T** - Tickseed, threadleaf (*Coreopsis verticillata*)
 - Ta** - Tansy (*Tanacetum vulgare*)
 - Th** - Bull Thistle (*Cirsium vulgare*)
 - Tu** - Pink Turtlehead (*Chelone lyonii*)
 - Vi** - Violet (*Viola sororia*)
 - Vib** - Hobblebush Viburnum (*Viburnum lantanooides*)
 - Ver** - Tall Verbena (*Verbena bonariensis*)
 - Vin** - Creeping Myrtle (*Vinca minor*)
 - Wit** - Witchhazel (*Hamamelis virginianum*)
 - Y** - Yarrow (*Achillea millefolium*)

Spring		Summer	
Early summer		Late Summer	
		Fall	